







The Site

-  Primary Points of Entry / Exit
-  Secondary Points of Entry/Exit
-  Pedestrian Circulation
-  Outdoor Plaza / Green Space
-  Vehicular Circulation
-  Tanner Dance Parking
-  Shuttle Circulation

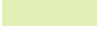

NORTH

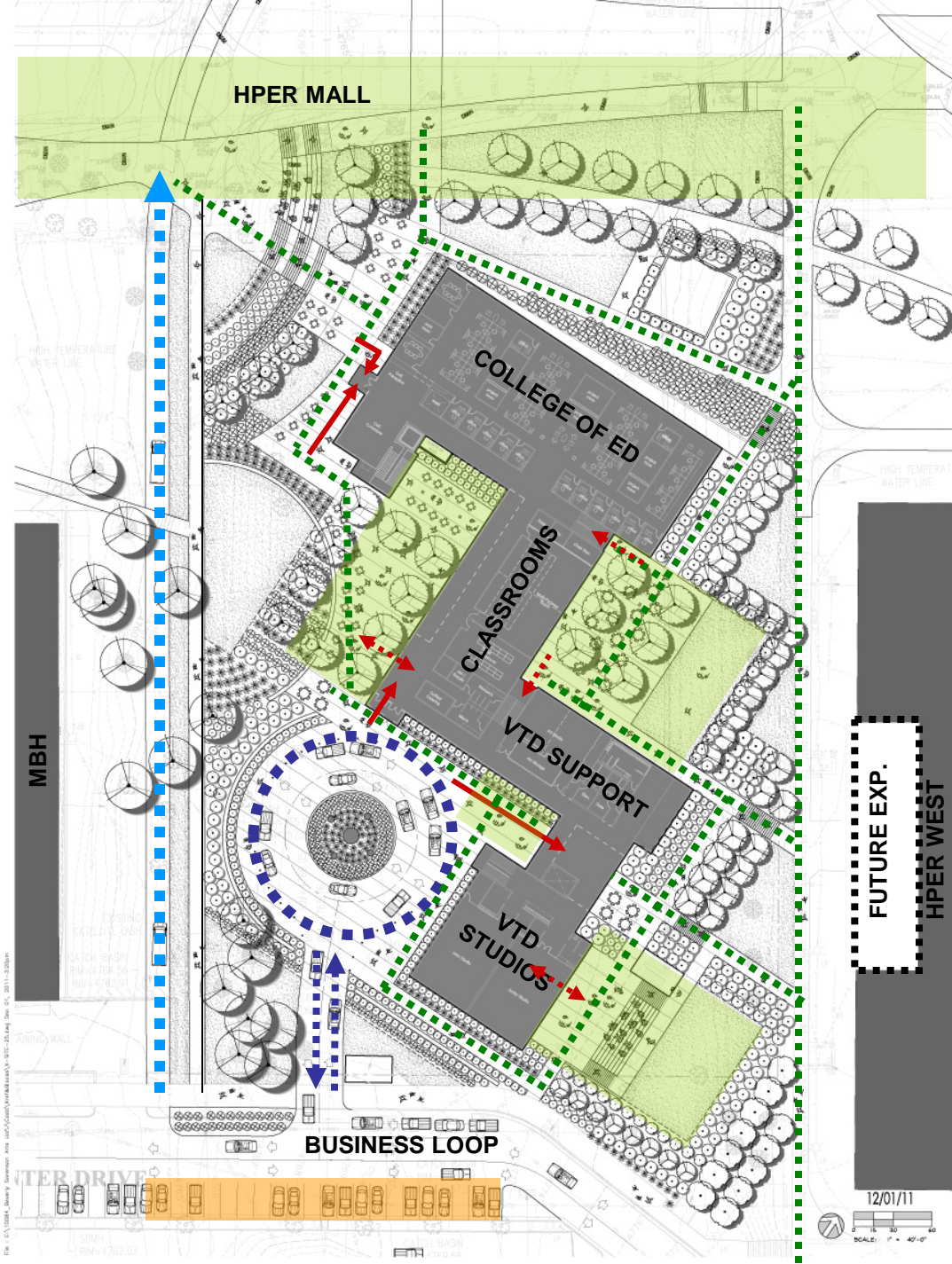

FUTURE EXP.
HPER WEST

12/01/11

SCALE: 1" = 40'-0"